

Rea Bellis

assembly instructions
accessories



English

Contents

16"-transportwheel	4
Fitting a one-arm brake	4
Foot brake (only for 16" wheels, seat height 47 cm)	5
Fit an adjustable backrest	6
Adapt to electrically operated seat tilt and backrest tilt adjustments.	8
Fitting the battery	10
Neckrest/headrest	11
Fitting detachable trunk supports	12
Fitting trunk supports	13
Safety belt	14
Height adjustment of height-adjustable armrests	14
Height adjustment of flip-up armrests or hemiplegic armrests	14
Remove the push bar and fit a push handle bar	15
Comfort backrest pad "Laguna"	16
Central legrest	17
Fitting heel straps to the foot plate	18
Fitting heel straps to the foot plate extension	18
Fitting the foot plate extension	19
Reflectors on the rear and sides of chairs with 20"-24" wheels	19
Reflectors on the rear and sides of chairs with 16" wheels	19
Pommel	20
Table tray	21
Crutch holder	22
Incontinence cover	22

16" transport wheel

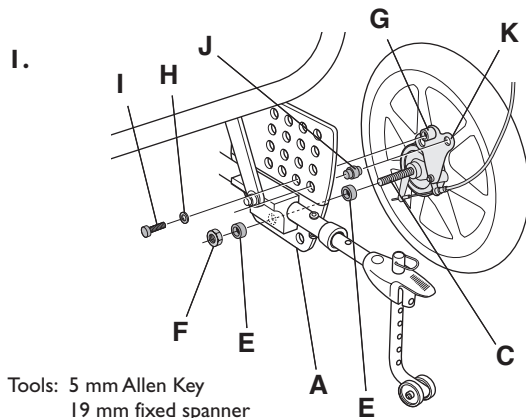

1. Start by fitting transport plate (A). Unscrew the screws on the drive wheel plate. The transport plate is screwed securely into the same holes and with the same screws as the drive wheel plate.

The transport wheel is then attached by inserting the axle (C) into the transport plate (A) with spacers (E) on both sides. The axle is attached securely with nut (F). The lock pin (G) is attached securely with washer (H) and screw (I). Lock spacer (J) is placed between the drive wheel plate and attachment plate (K).

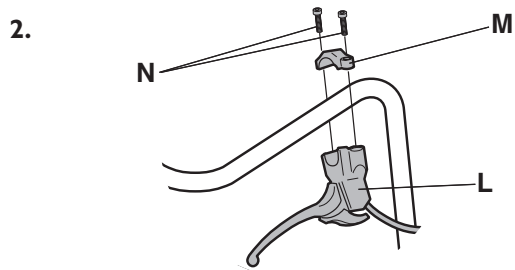

2. In order to fit the push handle, you hold handle (L) on the underside of the push handle/push bar and clamp (M) on the upper side. Then attach these together securely using the screws (N).

Fitting a one-arm brake

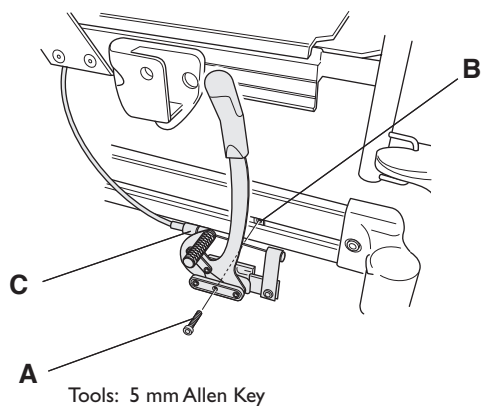

Start by removing the standard rear wheel brake. Attach the one-arm brake to the suitable side of the chair by tightening screw (A) in the existing square nut (B).

Adjust the braking effect when necessary by tightening/loosening the wire (C). Attach the wire to a suitable point on the underside of the chair using cable ties to keep it out of the way.

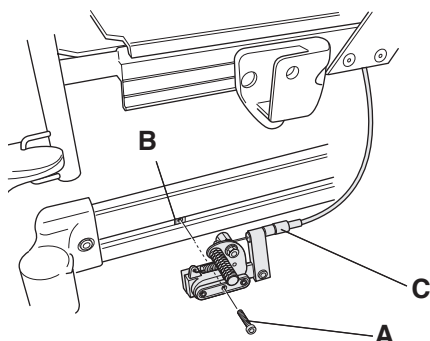

Foot brake (only for 16" wheels, seat height 47 cm)

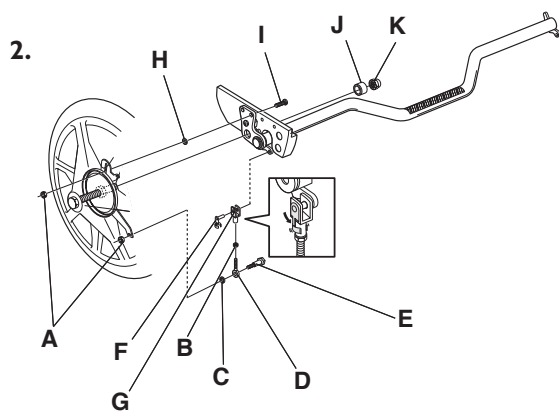
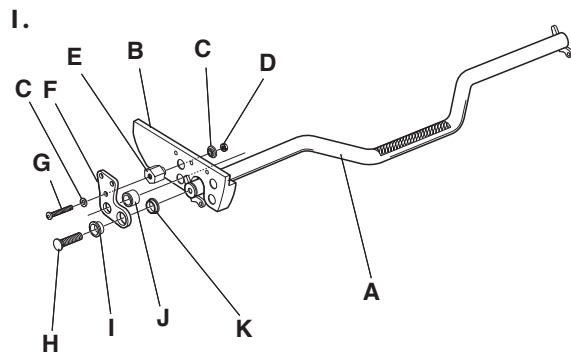

Tools: 4 mm Allen Key
5 mm Allen Key
7mm fixed spanner
10 mm fixed spanner
19 mm fixed spanner
19 mm box spanner

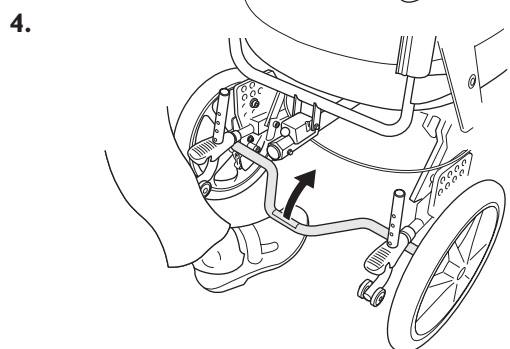
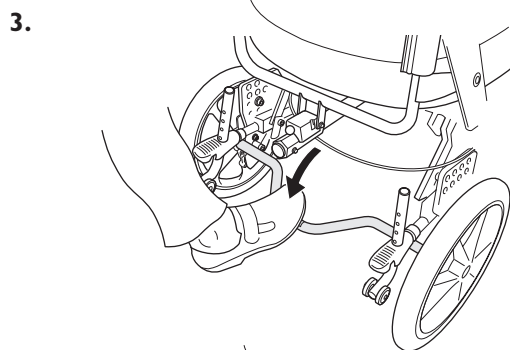

1. Fit screw (G) into mounting plate (F) and nut (E). Then fit link bushing (K) into the hole on the inside of mounting plate (F). Fit link washer (I) into the hole on the outer side of mounting plate (F). Tighten using screw (H) through the bushings to brake tube (A).
Fit nut (E) in the required position on transport wheel plate (B). Sleeve (J) is to be fitted into the hole on the mounting plate and everything is to be securely locked into place on the transport wheel plate using nut (D) and washer (E).
2. Fit nut (B) onto eye bolt (D). Fit eye bolt (D) to the brake arm on the transport wheel using screw (E). Fit washer (C) between eye bolt (D) and the brake arm and tighten nut (A). Then fit fork link (G) onto eye bolt (D). Press axle (L) securely onto the transport wheel through the mounting plate. Lock into place using washer (H) and screw (I). Tighten with nut (A). Lock the wheel into position with washer (J) and nut (K). Turn the fork link upwards and lock it into place onto the brake tube with lock clip (F). Follow the same procedure for the other side.

It is easiest to adjust the brake if you turn the wheelchair upside down.

1. Loosen nut (B).
 2. Loosen lock clip (F) and pull it out.
 3. Turn fork link (G) outwards to adjust the braking effect.
 4. Lock fork link (G) into place with lock clip (F) and tighten nut (B).
 5. Adjust fork link (G) by an equal amount on both sides.
 6. Test to check that the braking effect is even, by spinning both wheels and braking. Both wheels should now be braked simultaneously.
 7. Turn over the chair so that the wheels are on the ground, and then test the brakes.
 8. If additional adjustment is necessary, repeat steps 1-5.
3. Press down the foot brake tube with your foot to apply the brake.
 4. Push the foot brake tube upwards with your foot to release the brake.

Fit an adjustable backrest

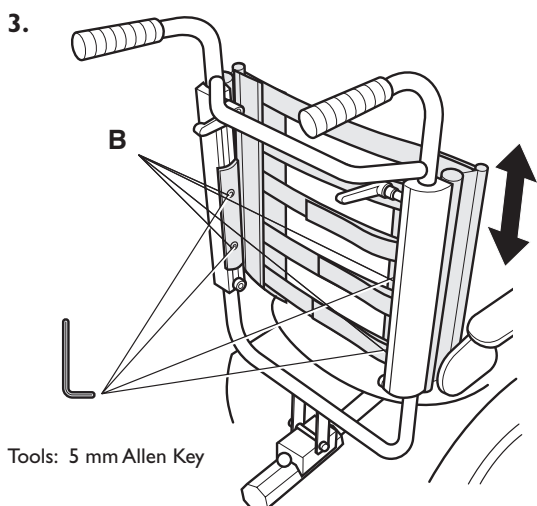
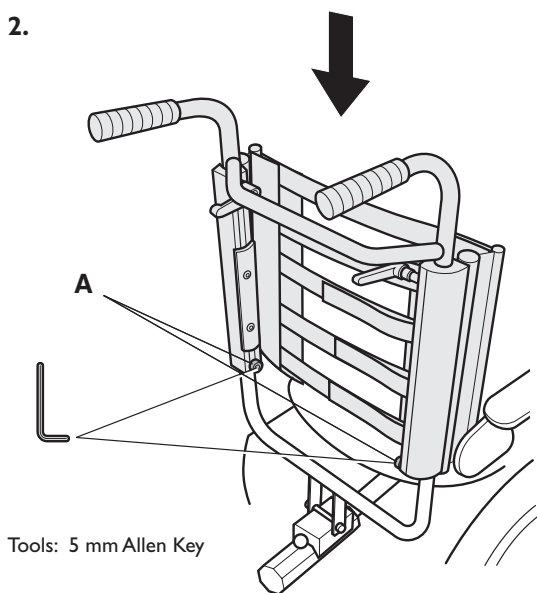
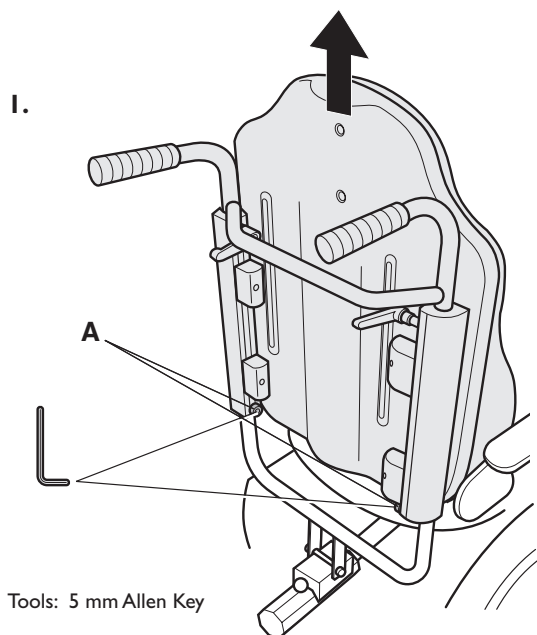

1. Start by removing the push bar or the push handle bar. Then remove the existing backrest by loosening both of the lower screws (A).

2. Fit the new adjustable backrest and tighten the screws (A).

3. The height of the backrest can be adjusted using the four screws (B).

4.

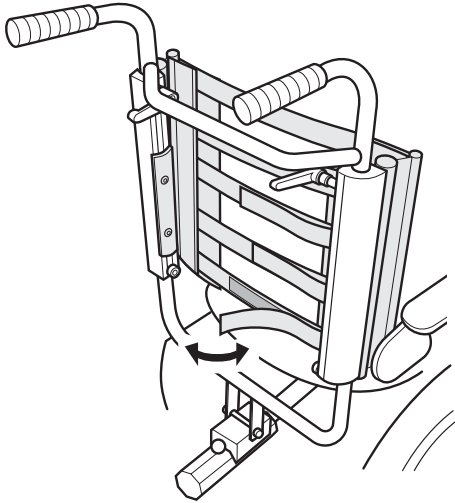

4. Adjust the backrest to the shape that you require using the Velcro straps.

5.

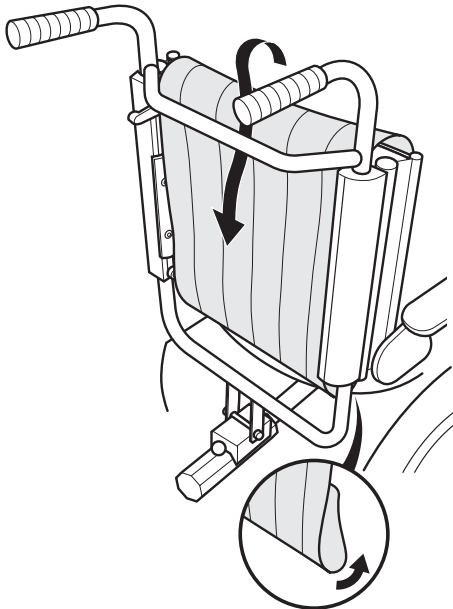

5. Fold the backrest cover over the backrest and secure it into place as shown in the diagram. The cover can be folded upwards at the bottom if necessary (see the enlarged detail in the diagram), depending on how low the backrest is placed on the wheelchair.

Adapt to electrically operated seat tilt and backrest tilt adjustment

1.

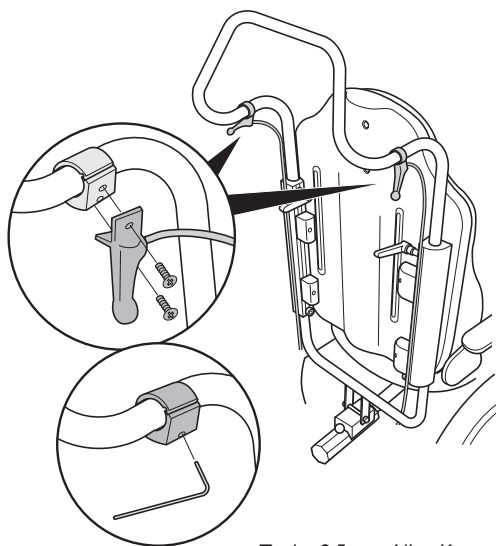

Tools: 2,5 mm Allen Key screwdriver

1. Start by loosening both of the tilt adjustment handles with their attachments on the push bar.

2.

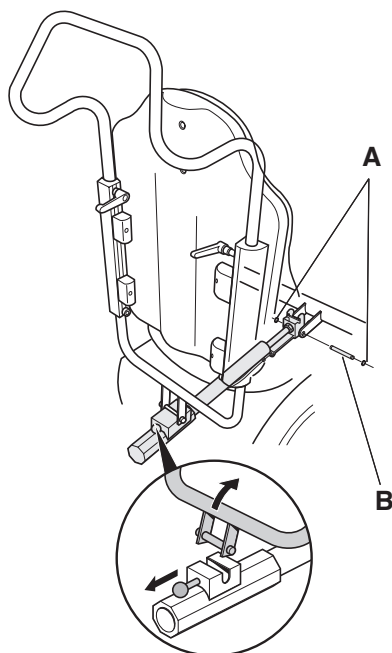

Tools: Ciclip pliers

2. Release the backrest with the pin on the back of the backrest tilt piston. Loosen this piston from its attachment under the seat by removing the circlips (A) and the dowel (B).

3.

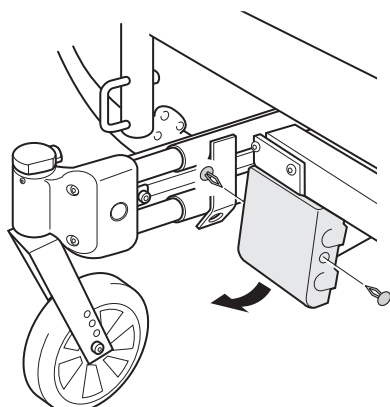

3. Then remove the protective casing of the seat tilt piston by loosening the clips on both sides.

4.

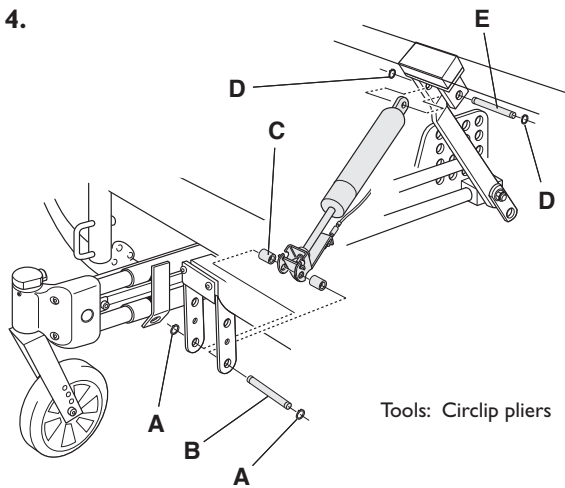

4. Remove the front seat tilt piston by loosening the circlips (A) and removing the dowel (B), the spacers (C) and then loosening the circlips (D), removing the dowel (E) and loosening the piston from its attachment at the rear of the chair.



NB! There is a major risk of you or the user sustaining trapping injuries when the seat tilt piston has been removed.

5.

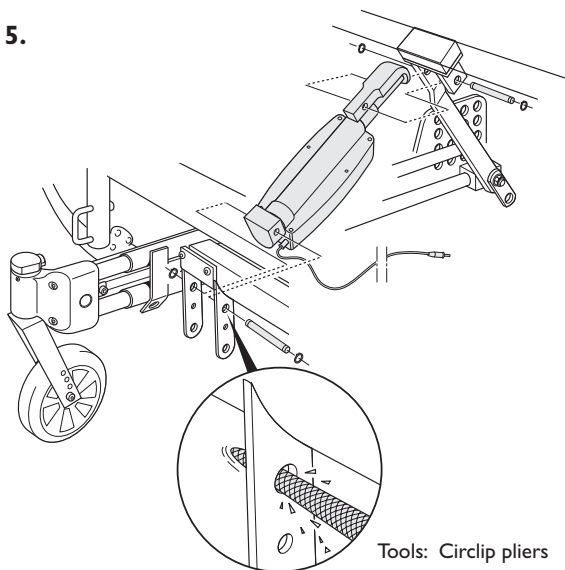

5. Fit the electrically operated seat tilt piston there instead, using the same circlips and dowels as when you removed the seat tilt piston. Note that the frontal piston is to be fitted into the upper hole of the attachment. If it is difficult to feed the dowel into place, you must enlarge the hole on the attachment slightly by removing paint.

6.

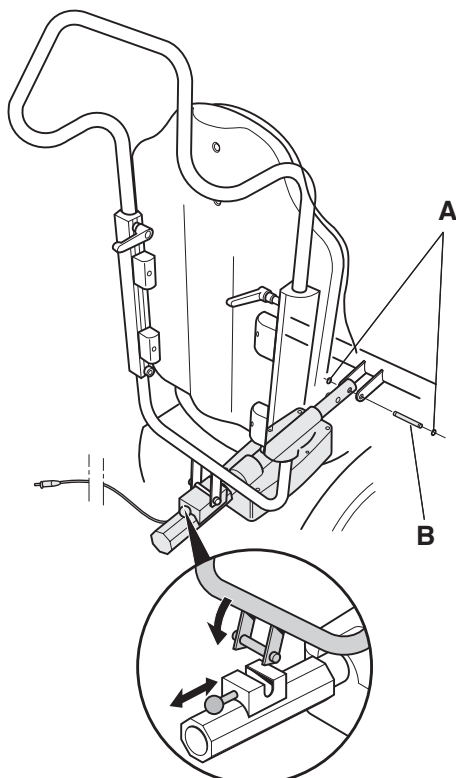

6. Fit the electrically operated backrest tilt piston into its attachment under the seat with the circlips (A) and the dowel (B). Attach the piston to the backrest arch using the pin at the back.



Ensure that it "clicks" into the attachment securely.

FITTING THE BATTERY

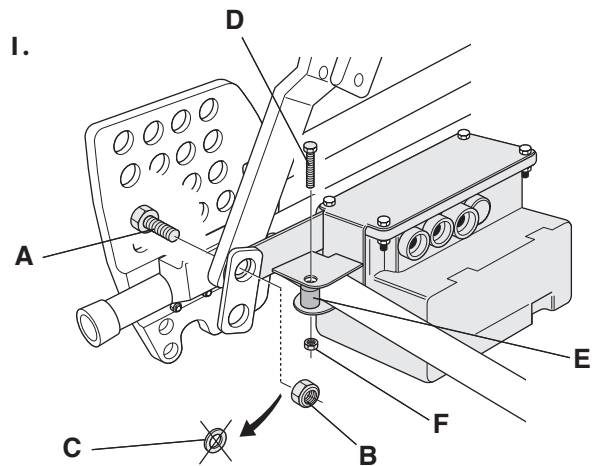

Tools: 5 mm Allen key
10 mm fixed spanner
17 mm fixed spanner

1. To fit the battery under the seat, the existing screw (A) and nut (B), which are by the rear wheel plate, are to be used. The existing washer (C) does not need to be included. When these details have been fitted, the battery must also be attached around the cross tube using the screw (D), spacer (E) and nut (F).

2.

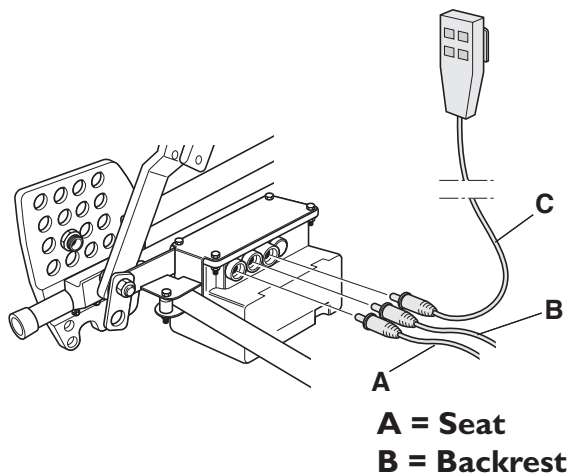

2. Connect the cables from the seat tilt piston (A), the backrest tilt piston (B) and the control box (C) according to the diagram. Fix hanging cables at suitable points under the chair using cable ties, to keep them out of the way

Neckrest/headrest

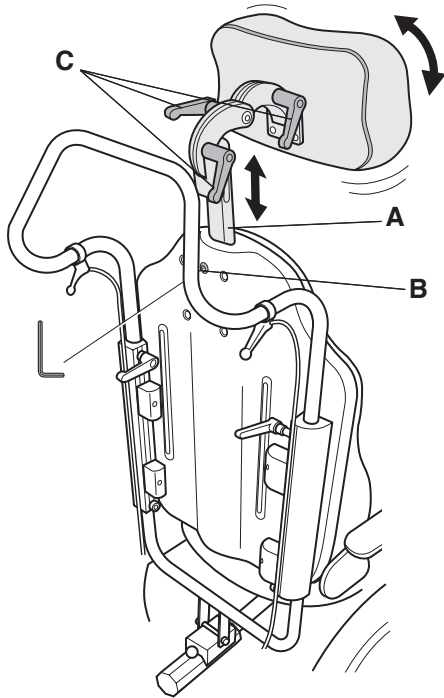

You adjust the height of the central support (A), by loosening handwheel (B), adjusting to the desired height and retightening. The angle and height of the neck rest are adjusted by loosening the levers (C). Change to the desired position and retighten the handwheels.



The central support (A) must not remain on the chair if the neck rest is removed.

ADJUSTABLE HEADREST/NECKREST

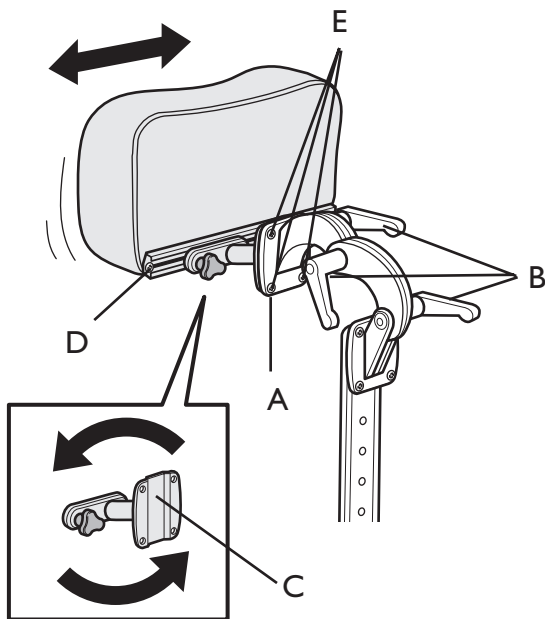

To adjust the neckrest/headrest sideways loosen the knob/screw (A). Adjust to a new position and tighten the knob/screw (A). Adjust the angle and height by loosen the handles (B). Change to a new position and tighten the handles (B).

To get maximum sideways movement you can turn around the attachment (C). The knob/screw (A) should sit on the left side of the attachment to get maximum sideways movement to the left and on the right side of the attachment to get maximum sideways movement to the right.

Take away the attachment (C) by loosen the screws (E) and the screw (D), take out the attachment and turn around to required position. Re-tighten the screws (E) and the screw (D).



If the neckrest/headrest has been taken away, The centre rod mustn't be left on the chair.

Detachable trunk supports

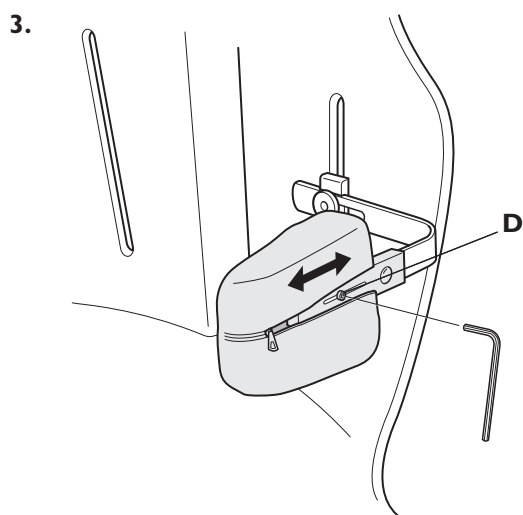
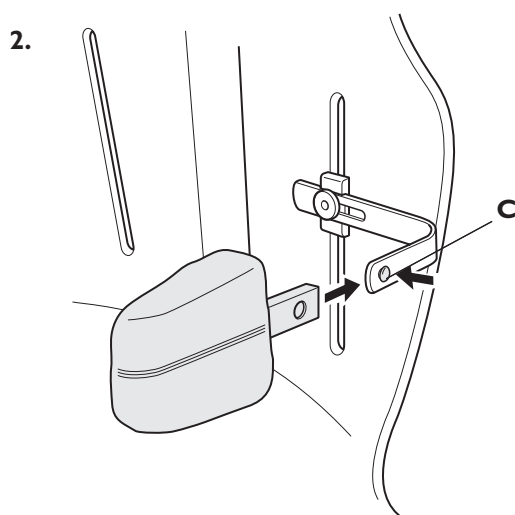
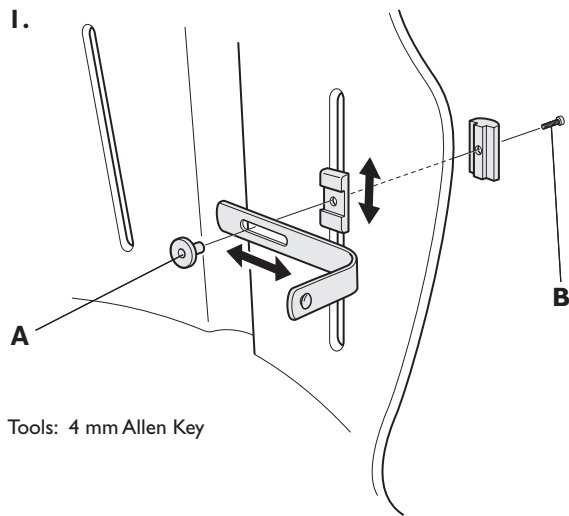

Tools: 5 mm Allen Key

1. Remove the backrest pad and fit both halves of the trunk support attachment into the grooves on the backrest. Use sleeve nut (A) and screw (B) to fit the "insert bracket" into the trunk support attachment. Loosen screw (B) to adjust the width and height of the trunk support.

Press the trunk support pad with its sleeve tube onto the insert bracket.

2. Press the lock button (C) to remove the trunk support pad.



NB! Ensure that the lock button (C) on the insert bracket is in its correct position on the sleeve tube of the trunk support.

3. You can use the screw (D) to adjust the depth of the trunk support pad.

Trunk supports

1.

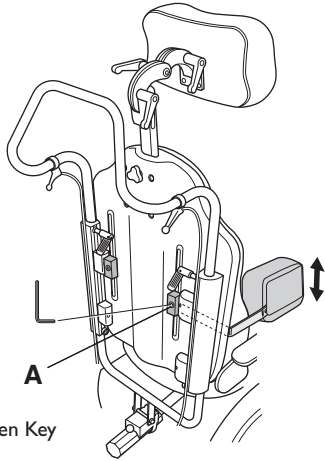

Tools: 4 mm Allen Key

1. You adjust the trunk support attachment by loosening screw (A) using a 4 mm Allen key. Adjust to the position that you require and retighten the screw.

2.

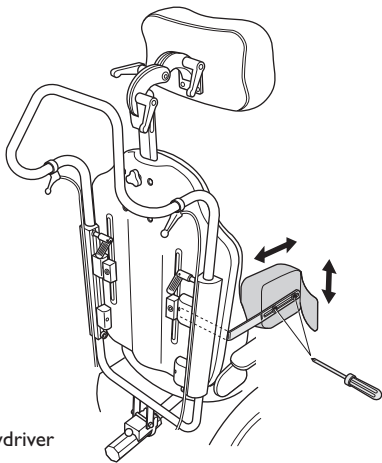

Tools: screwdriver

2. You can open the trunk support pad using the zip. You can then adjust the trunk support by loosening the two screws using a Phillips screwdriver and moving the trunk support forwards or backwards. Retighten the screws and close the zip.

Safety belt

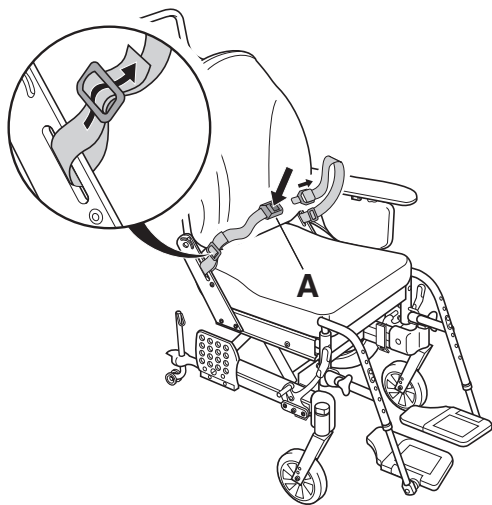

Feed the belt through the slits on each side of the wheelchair. Adjust the belt to a suitable length. Undo the belt by pressing button (A).

Armrest height adjustment

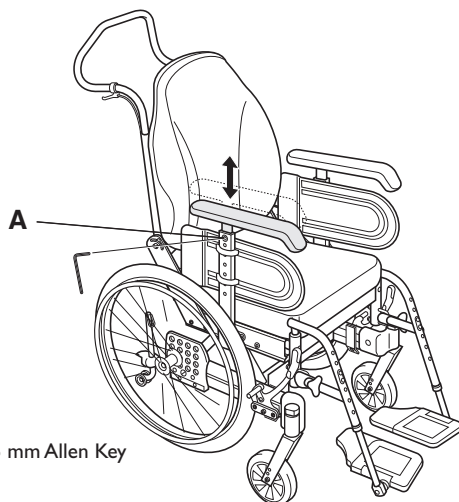

Adjust the height of the armrest using screw (A).

HEIGHT ADJUSTMENT

FLIP-UP- OR HEMIPLEGIC ARMREST

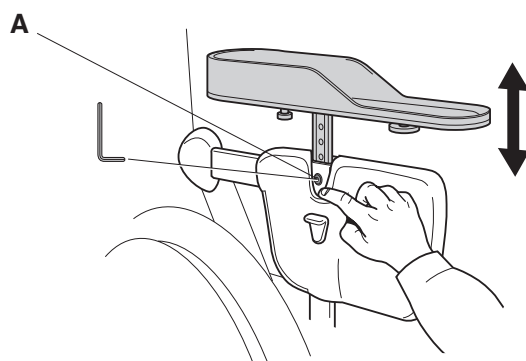

Adjust the height of the armrest using screw (A).

Tools: 5 mm Allen Key

Remove the push bar and fit a push handle brace

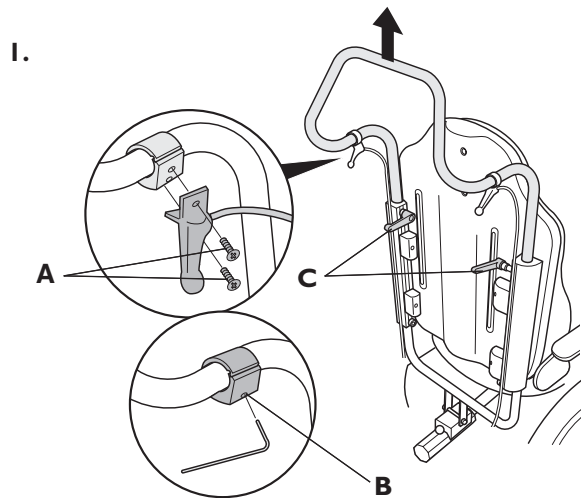

Tools: 2,5 mm Allen Key
screwdriver

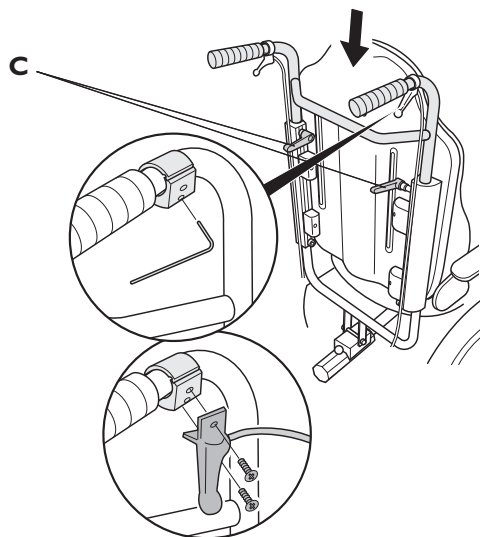

2.

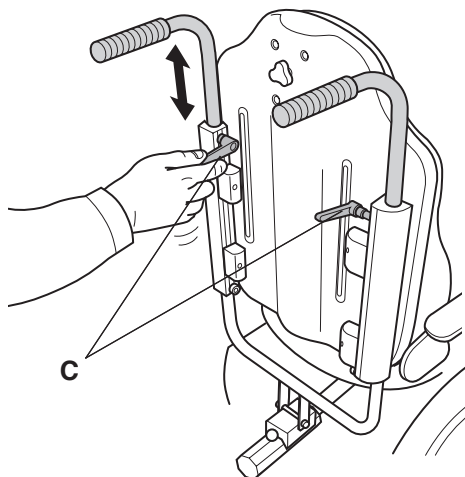

- I. To replace the push bar with a push handle bar, you must first remove the handles for the backrest tilt and the seat tilt adjustments. The tilt handles must be moved from the push bar to the push handle bar.

Start by loosening both of the screws (A) and removing the backrest tilt handle from its attachment. Then remove the attachment with the screw (B).

Do the same with the seat tilt handle and its attachment.

Loosen both levers (C) and remove the push bar. Fit the new push handle bar, adjust to the required height and lock into place using the levers (C). Fit the attachments, the backrest tilt handles and seat tilt handles as before.



NB! To ensure that both tilt handles fit onto the push handle bar, they must be angled outwards slightly, unlike their earlier positioning on the push bar.

3. Adjust the height of the push handles brace/push bar by loosening the levers (A) and then moving the push handles brace/push bar upwards or downwards until you have reached the desired height. Then retighten the levers.



The push handles brace must not be pulled up so that it protrudes more than 19 cm over the top edge of the attachment.

Comfort backrest pad “Laguna”

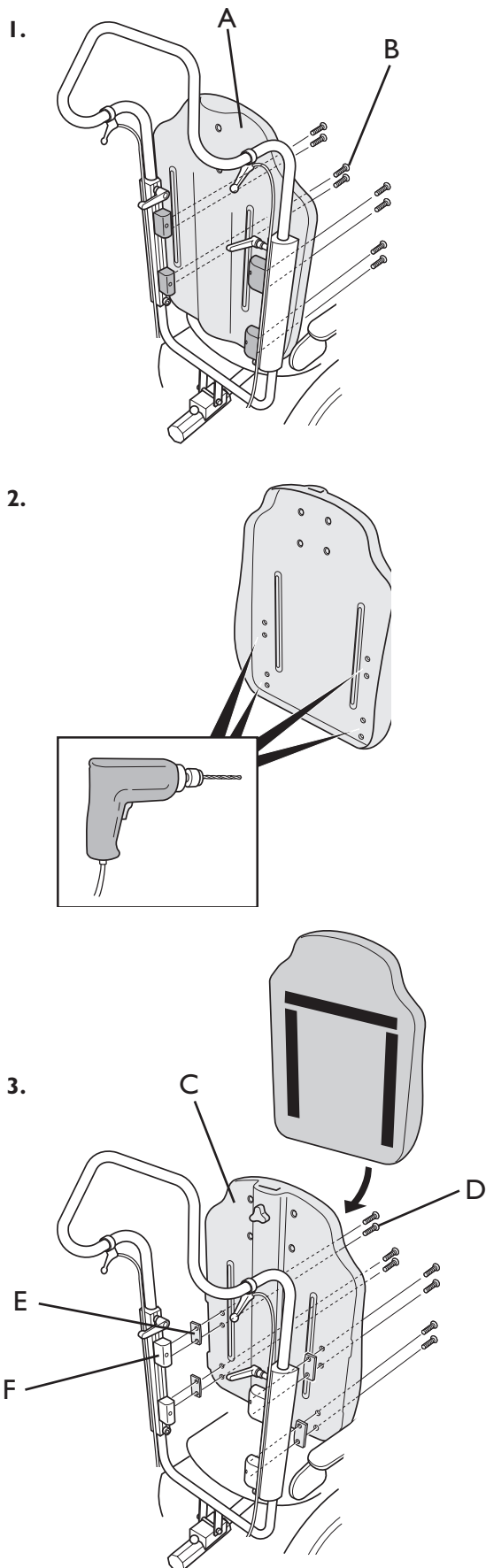

You can equip the wheelchair with a slightly thinner type of backrest pad; “Laguna”. This pad allows greater freedom of movement than the standard backrest pad.

1. Start by removing the existing plastic backrest (A) by loosening its 8 attachment screws (B) on the inside of the plastic backrest.

2. Drill 8 holes according to the holes shown on the new plastic backrest.

3. Fit the new plastic backrest (C) using 8 screws (D) as shown in the diagram. Do not forget that the spacers (E) must be placed between the plastic backrest and the mounting plate (F) on each backrest tube. Finally fit the comfort backrest pad into the plastic shell.

4.

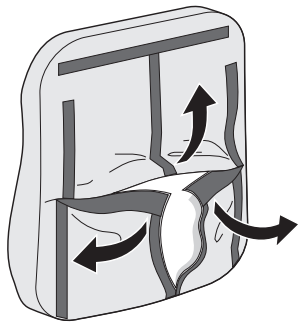

4. The Laguna pad has Velcro strips on the back of its cover and is inserted into the plastic shell casing in the place where the standard pad is otherwise fitted. The pad's cover can be removed and washed according to the washing instructions. Remove the cover by unzipping it and pulling it off the pad.

Central legrest

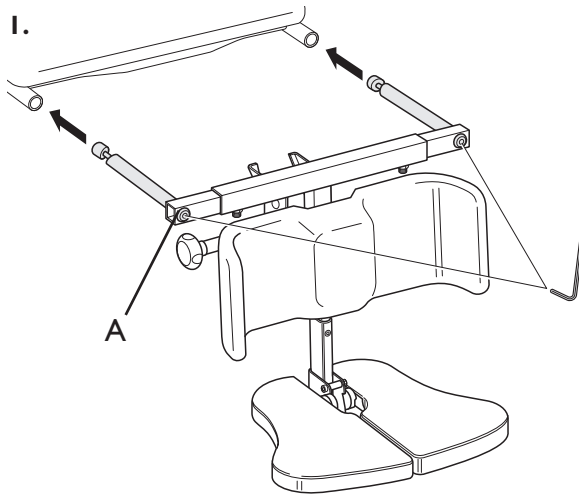

1. If you want to fit a central legrest to the wheelchair, you must first remove the existing seat extension. Use an Allen key to loosen both screws (A). Then fit the central legrest, set the required seat depth and tighten the screws (A).

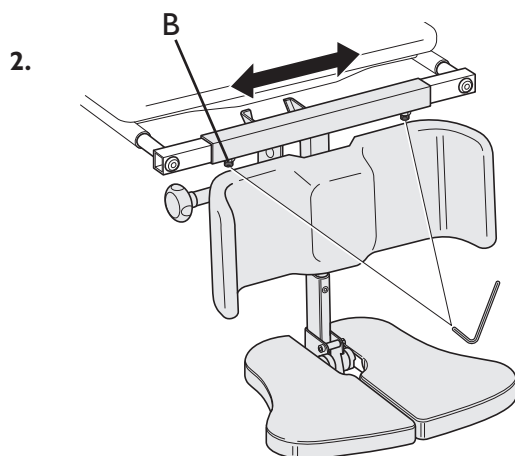

2. Adjust the legrest to a central position by loosening both Allen screws (B) as shown in the picture. When you have found the desired position, retighten the screws.

Fitting heel straps to the foot plate

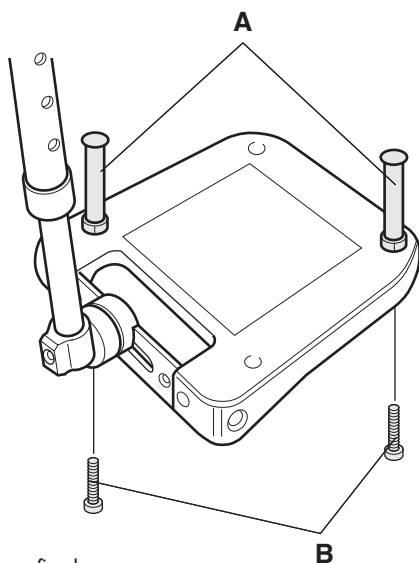

Tools: 10 mm fixed spanner
screwdriver

Fasten the heel strap guiding pins (A) into the holes on the foot plate using the screws (B).

Note that only two of the holes are used.

Fit the heel straps around each guiding pin and adjust the shape and depth, etc. using the velcro straps.

Fitting heel straps to the foot plate extension

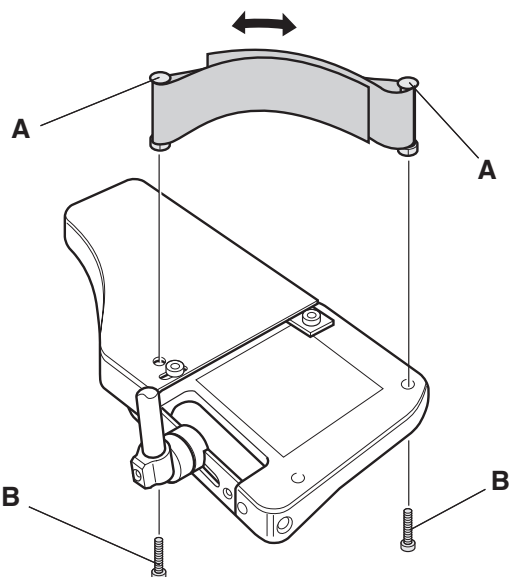

Tools: 10 mm fixed spanner
screwdriver

When using the foot plate extension, the heel strap guiding pins (A) must be secured using the screws (B) as shown in the diagram.

Note that only two of the holes are used.

Fit the heel straps around each guiding pin and adjust the shape and depth, etc. using the Velcro straps.

Fitting the foot plate extension

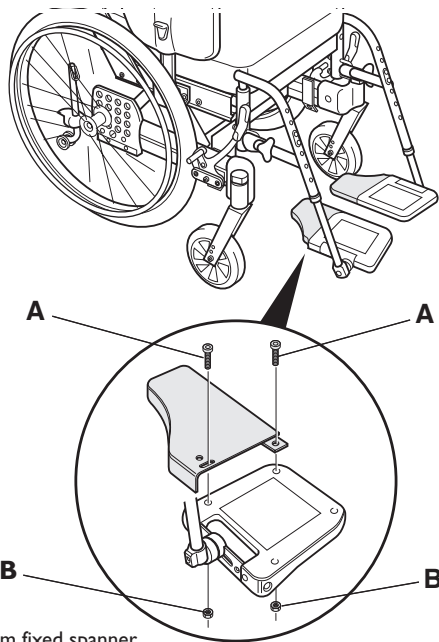

Fit the extension to the foot plate using the screws (A) and nuts (B).

Tools: 3 mm fixed spanner
screwdriver

Reflectors

ON THE REAR AND SIDES OF CHAIRS WITH 20"-24" WHEELS

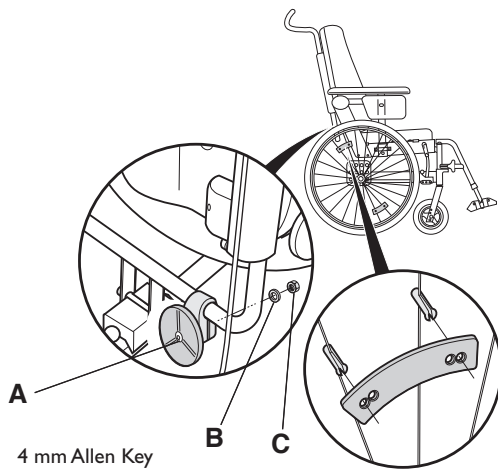

Fit the red reflector on the back of the backrest tube using the screw (A), washer (B) and nut (C). Attach the orange reflector to the spokes of the rear wheels, by placing both clips (D) at a suitable distance from each other, each of them around a spoke, and then pushing the reflector onto it.

NB! Ensure that the circlips are pressed through the holes on the reflector sufficiently. If not, the reflector can fall off.

Tools: 4 mm Allen Key
10 mm fixed spanner

ON THE REAR AND SIDES OF CHAIRS WITH 20"-24" WHEELS

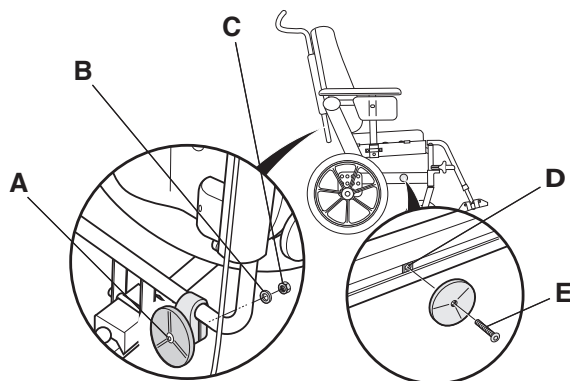

Attach the red reflector to the back of the backrest tube using the screw (A), washer (B) and nut (C). If the wheelchair is equipped with 16" wheels the orange reflector must be attached to the side of the wheelchair using the screw (D) and the square nut (E).

Tools: 4 mm Allen Key
10 mm fixed spanner

Pommel

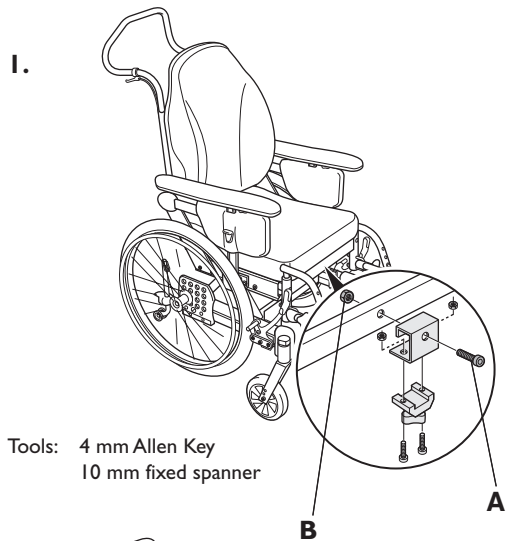

Tools: 4 mm Allen Key
10 mm fixed spanner

1. Fit the pommel attachment to the front of the chair using the screw (A) and nut (B).

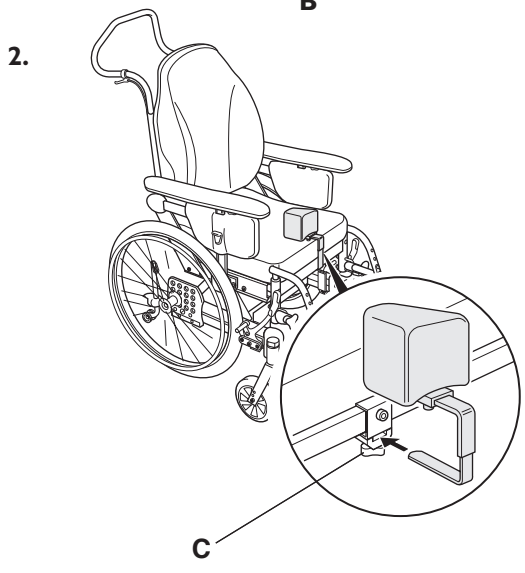

2. Lock the pommel into the attachment by tightening the knob (C) underneath.

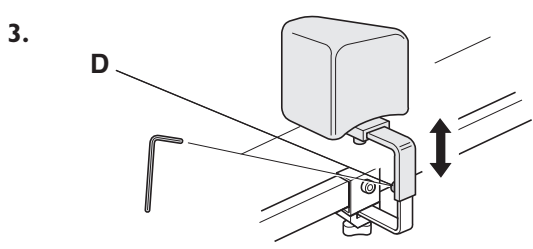

Tools: 5 mm Allen Key

3. Adjust the height of the pommel using the screw (D).

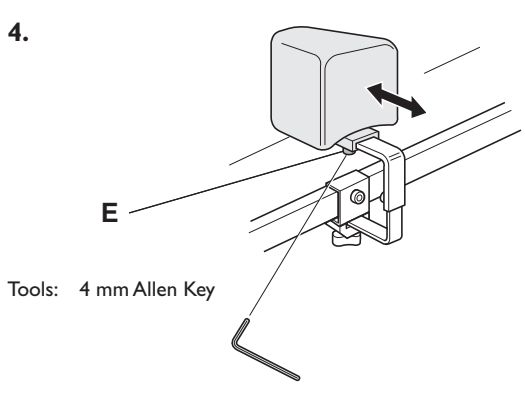

Tools: 4 mm Allen Key

4. Adjust the depth of the pommel using the screw (E).

Table tray

1.

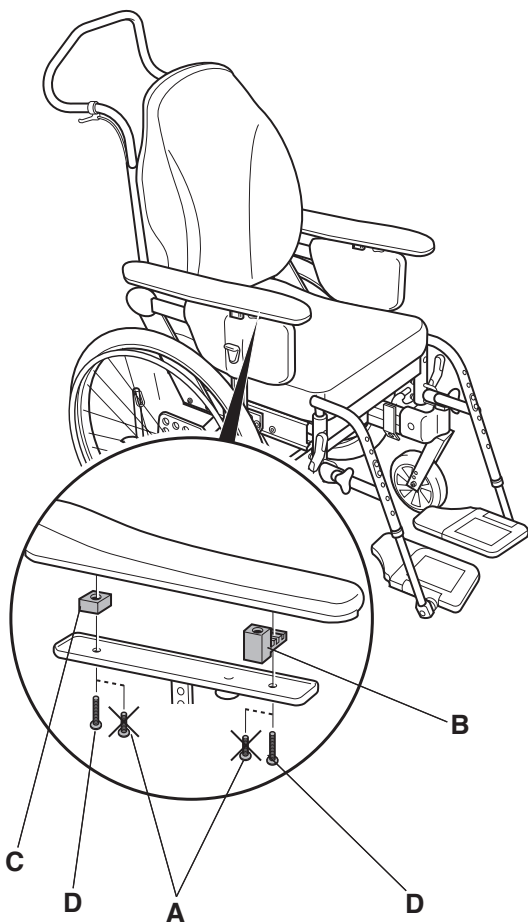

1. Loosen the screws (A) on the underside of the armrest. Remove the armrest pad. Fit the table tray's attachment casing (B) and spacer block (C) between the armrest pad and its attachment plate. Attach the armrest pad with the new screws (D).

2.

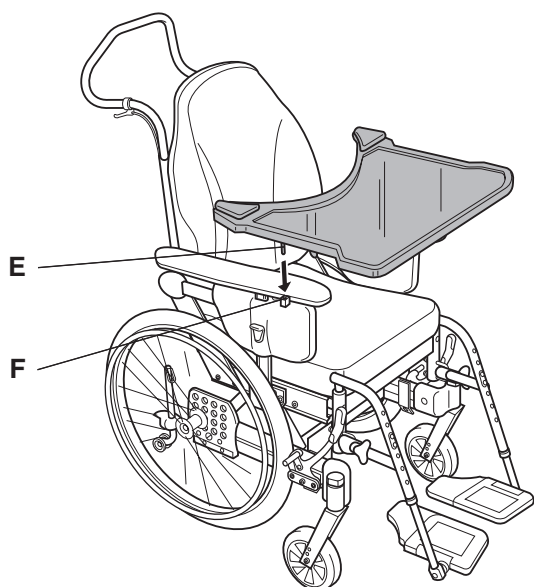

2. The table tray is attached by putting the pins (E) into the attachment casings (F) and pushing them down into place.

Crutch holder

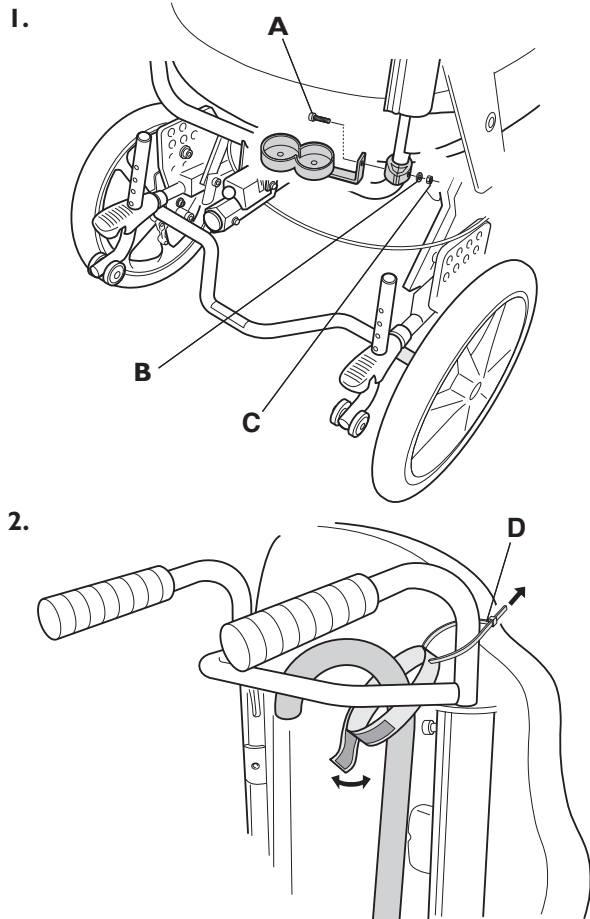

1. Fit the crutch holder attachment around the backrest tube using the screw (A), washer (B) and nut (C).

2. Attach the Velcro strap around the push handle using the cable tie (D).

Adjust the Velcro strap around the crutch or walking stick as necessary.

Incontinence cover

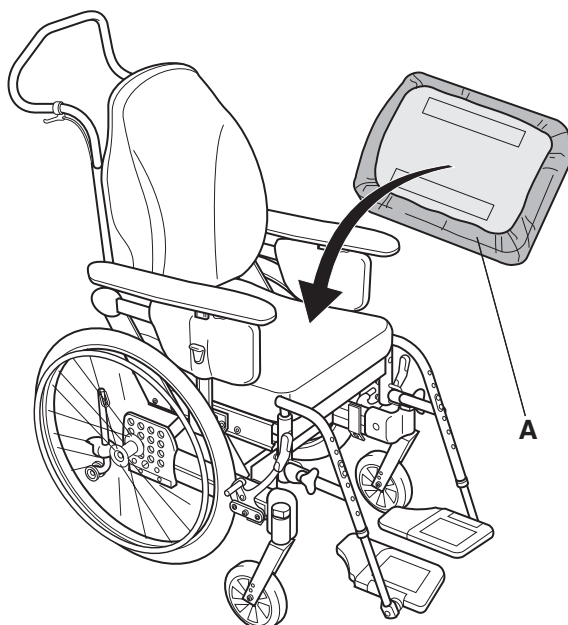

Remove the seat pad, pull the incontinence cover (A) over the pad and put the pad back into the chair.



THIS SYMBOL MEANS WARNING.

Failure to comply can result in personal injury and/or damage to the wheelchair.

Those fitting accessories should ensure that:

- They are careful not to trap their fingers when carrying out assembly work.
- They are careful to ensure that all knobs, screws and nuts are properly tightened.
- They are careful to ensure that the drive wheels are properly fixed to the wheelchair.

For further information regarding the wheelchair model shown in this assembly manual refer to the model's main manual.

Manufacturer:



Invacare Rea AB
Växjövägen 303 S-343 71 DIÖ SWEDEN

Sales companies:

Belgium:

Invacare n.v.
Autobaan 14
B-8210 Loppere, Brügge
Tel. +32 - 50 83 10 10
Fax. +32 - 50 83 10 11

Denmark:

Invacare A/S
Sdr. Ringvej 39
DK-2605 Brøndby
Tel. +45 - 36 90 00 00
Fax. +45 - 36 90 00 01

Finland:

Invacare Apuvaline OY
Kumpulantie 1
00520 HELSINKI
Tel. +358 (09) 22 95 40
Fax. +358 (09) 229 544 04

France:

Invacare Poirier S.A
Les Roches
F.37230 Fondettes
Tel. +33 - 02 47 62 64 66
Fax. +33 - 02 47 62 64 10

Germany:

**Austria, Switzerland
and Eastern Europe.**
Invacare GmbH
Dehmer Strasse 66
D-32549 Bad Oeynhausen
Tel. +49 - 57 31 754 0
Fax. +49 - 57 31 754 150

Holland:

Invacare B.V.
Celsiusstraat 46 / P.O. Box 123
NL-6710 BC Ede
Tel. +31 - 318 695757
Fax. +31 - 318 695758

Italy:

Meccan SARL
Via Ddei Pini, 64
IT- 36016 Thiene VI
Tel. +39 - 445 380059
Fax. +39 - 445 380034

Norway:

Invacare AS
Grønsevingen 9
P.O. Box 6230 / Etterstad
N-0603 OSLO 6
Tel. +47 - 22 57 95 00
Fax. +47 - 22 57 95 01

Portugal:

Invacare Lda
Rua Senhora de Campanhã
PT- 4369-001 Porto
Tel. +35 - 12 510 59 46
Fax. +35 - 12 510 57 39

Spain:

Invacare S.A
C/Areny, s/n
Polígono Industrial de Celerá
S- 17460 Celrà (Girona)
Tel. +34 - 972 493200
Fax. +34 - 972 493220

Sweden:

Invacare AB
Fagerstagatan 9 / Box 66
S-163 91 Spånga
Tel. +46 - 8 761 70 90
Fax. +46 - 8 761 81 08

United Kingdom:

Invacare (UK) Ltd.
South Road, Bridgend Industrial
Estate
Bridgend
County Borough of Bridgend CF31
3PY
United Kingdom
Tel.: +44 1656 664 321
Fax.: +44 1656 667 53